



**COROMAL**  
C A R A V A N S

# Silhouette

THE CAMPER OF THE FUTURE

Experience the ultimate camping lifestyle in the luxury of this feature packed Camper.



The Coromal Silhouette range offers:

- Unique slide-out kitchen for spaciousness never before achieved in a camper (most models)
- Easy-to-operate slide-out bed mechanism on heavy duty tracking
- Increased floor space, larger kitchen and bench area
- Luxury queen-size front bed standard (most models)
- Outstanding towing ability with Coromal's renowned independent suspension
- Revolutionary new one-piece fibreglass roof for extra strength
- Handy battery compartment is great when camping out
- One-piece, simple-to-operate main door
- Separate travel door section for extra table space when on site (most models)
- The huge front locker includes gas bottle storage with heaps of room to spare
- Strength and durability with the streamlined aerodynamic styling of the future



*“Experience the lifestyle.*

*Discover the freedom”*

# Silhouette

## THE CAMPER OF THE FUTURE

**COROMAL**  
C A R A V A N S

### Silhouette 32

3.2m x 2.16m (10'7" x 7')



S321

### Silhouette 39

3.9m x 2.16m (12'9" x 7')

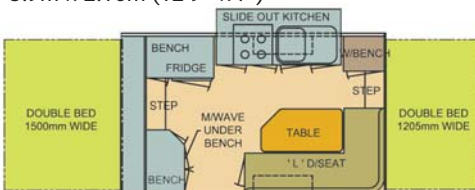

S391



S392

## Silhouette Features

Incorporated into most models is the unique new slide out kitchen providing increased interior space

### EXCLUSIVE FIBREGLASS CONSTRUCTION

- REVOLUTIONARY FIBREGLASS ROOF CONSISTING OF INNER & OUTER SKIN WITH AN INTEGRATED CORE CONSTRUCTION
- MOULDED FIBREGLASS FRONT & REAR SECTION
- FIBREGLASS SIDE PANELS BONDED TO AN ALUMINIUM FRAME
- FEATURING THE THOROUGHLY TIME TESTED & PROVEN INDEPENDENT SUSPENSION

### ALUMINIUM WALL FRAME CONSTRUCTION

- ELECTRIC BRAKES
- FULL LENGTH GALVANISED STEEL CHASSIS
- LARGE FRONT LOCKER
- STEEL BELTED LIGHT TRUCK RADIAL TYRES
- PLY FLOOR BONDED & FASTENED TO CHASSIS
- GALVANISED STEEL WHEEL ARCHES
- ALUMINIUM WATER TANK PROTECTOR
- DOUBLE PLY CUPBOARD DOORS
- POSITIVE LOCKING CATCHES
- SELF-CLOSING HINGES
- CO-AXIAL TV POINT
- TRAVEL DOOR/TABLE (NOT AVAILABLE IN S321)
- FRIDGE - 3 WAY RM2350
- STOVE 4B (1 ELECTRIC) & GRILL
- LARGE BOWL STAINLESS STEEL SINK WITH MOULDED COVER
- MICROWAVE OVEN - (NOT AVAILABLE IN S321)
- ROOF HATCH
- HEAVY GRADE PLASTIC WINDOWS
- CANVAS - SEPARATE PANELS UV STABILISED (AUST)

### SLEEVE COVERS TO LIFTING ARMS

- CANVAS LOCATED IN TRACK TO LEADING EDGE OF BED ENDS
- CANVAS LOCATED INTO CARAGROOVE TRACK EXTRUSION ON LOWER MAIN BODY SECTION
- FULL WIDTH WEATHER STRIP UNDER BUNKS
- SPARE WHEEL ON REAR BUMPER
- POLYURETHANE MOULDED STONE GUARD
- MAINS TAP & TAP ON A-FRAME
- EXTERNAL POWER POINT
- INSULATED ROOF AND WALLS
- BED LAMPS TO BED COMPARTMENTS
- 1 PIECE MAIN DOOR SLIDES INTO CEILING TRACK
- ANNEXE LIGHT

## Options

- PIONEER PACK
- EXTERNAL COLD SHOWER TO MOST MODELS

## Pioneer Option

STRONGER AND TOUGHER FOR THE MORE ADVENTUROUS, THE PIONEER OPTION IS AVAILABLE ON ALL SILHOUETTE MODELS. DETAILS ARE PROVIDED ON THE PIONEER BROCHURE.

### Silhouette 42

4.2m x 2.16m (13'11" x 7')

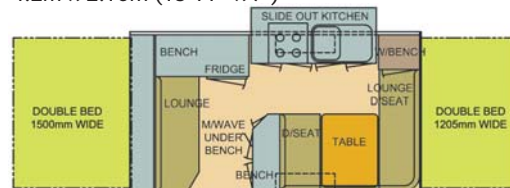

S421

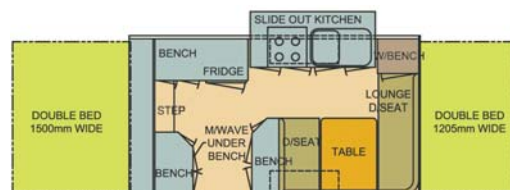

S422

### Silhouette 45

4.5m x 2.16m (15' x 7')

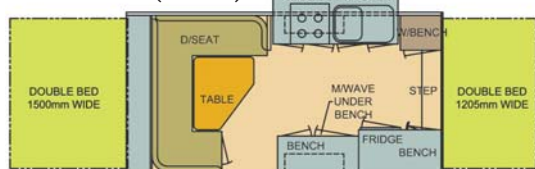

S451

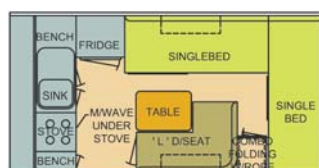

S453

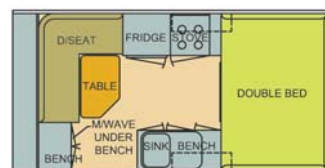

S454

## Specifications

MODEL No	INTERIOR LENGTH	BODY LENGTH	BODY WIDTH	TOWING LENGTH	TOWING HEIGHT (INC HATCH)	TARE WEIGHT
S32	2410mm	3230mm	2160mm	4380mm	1770mm	980kg
S39	3070mm	3900mm	2160mm	5050mm	1770mm	1050kg
S42	3400mm	4230mm	2160mm	5380mm	1770mm	1070kg
S451	3730mm	4560mm	2160mm	5710mm	1770mm	1100kg
S453/4	3730mm	4560mm	2160mm	5710mm	1770mm	1030kg

The weights shown are indicative weights and are meant as a guide only. They will vary from model to model, in particular when options are added.

Due to progressive product improvements all specifications are subject to change without notice, and not necessarily to scale.

Manufactured by Coromal Caravans Pty Ltd  
ABN 82 008 682 513

25 Harrison Road  
Forrestfield WA 6058  
Tel: 08 9352 0900  
[www.coromal.com.au](http://www.coromal.com.au)

Coromal sales centre

